

SYSTEM OF YOUR DRIVE

Drive system from A to Z - the
single source all-in-one package

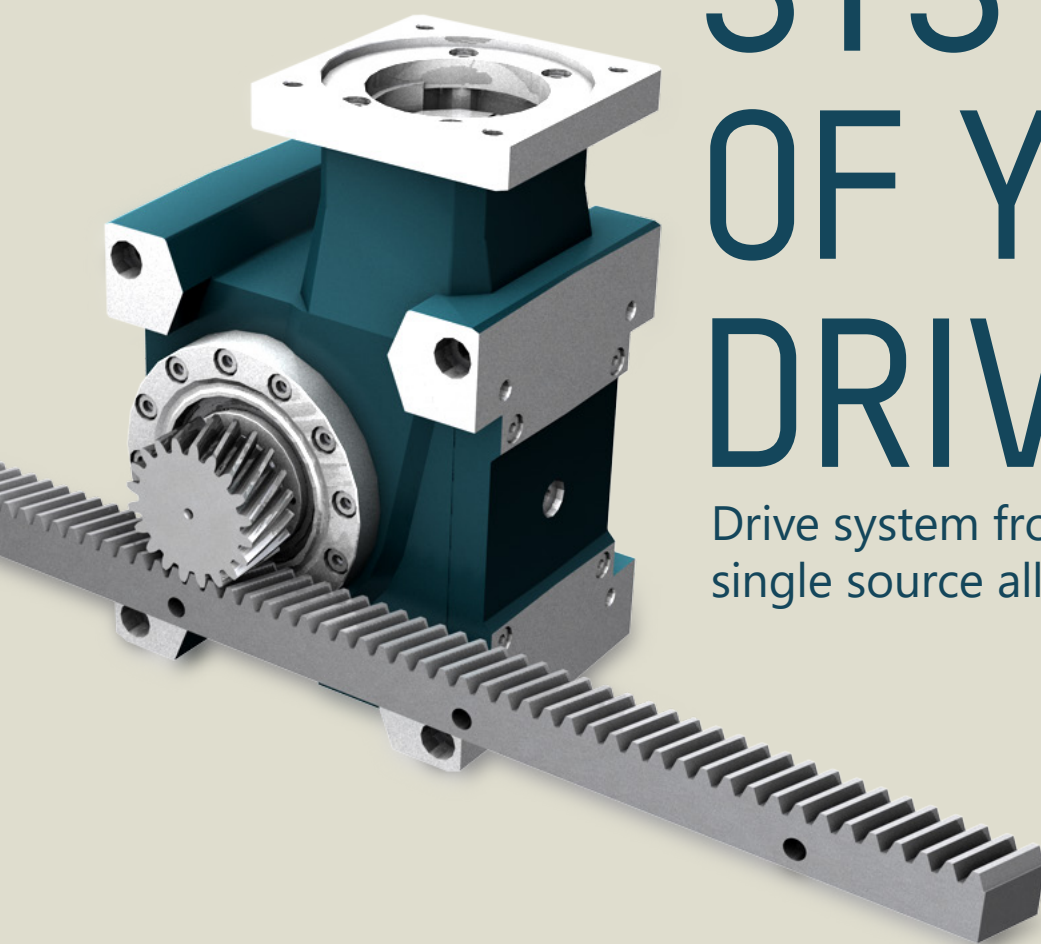

www.herionlinner.com

Systematic Drive

Simple modular system - designed for easy combination

The variety of diverse drive elements is almost endless. Whether it may be Spur Gears, Pinions, Racks, Servo Gears or even something completely different - we have got you covered! Both the component version, as well as varying material properties obviously have a major impact on potential applications. But how to choose the correct components for your individual project?

Take advantage of our **extensively modular system!** All Pinion Shafts, Racks and Servo Gears are not only precisely matched to each other, but also **available in a vast amount of different variations.** This is a major advantage since it allows you to solely focus on given project requirements without having to worry about potential compatibility issues.



Short delivery time

Based on the fact that we are mainly using standard components, respectively modified versions of those, availability is generally rapid.



Price - Performance ratio

Another advantage of using standard components is an excellent value for money. High quality components for fair costs.



Customized solutions

Standards are easy. But what if you want to realize something more special? Being masters in all three disciplines, Standard, Modified Standard or even highly customized parts, we are able to find appropriate solutions for all of your challenges.



Application Areas

The right kit for every application

Do you already have a thorough understanding about operational requirements of your planned project? Great! You can simply go ahead and refer to the technical data sheets of our modular system. As mentioned before, all components are perfectly matched to each other and can easily be integrated into your concept.

In case you may not have specific information about operational requirements just yet, we will be happy to share our expertise with you. Together we will be able to find a suitable solution for your needs.

BENEFITS APPLICATION



designed for highly dynamic servo applications

very high positioning accuracy

extreme overload capacity

suitable for packaging of food, cosmetics and for pharmaceutical products

new bearing concept for high external forces

System solutions



Conveyor technology

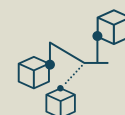

Intralogistics



Packaging machines



Handling systems



Robotics & automation technology



Health-Care & Pharma Industry



Industrial & Assembly machinery



Machine tools



Test engineering & process engineering

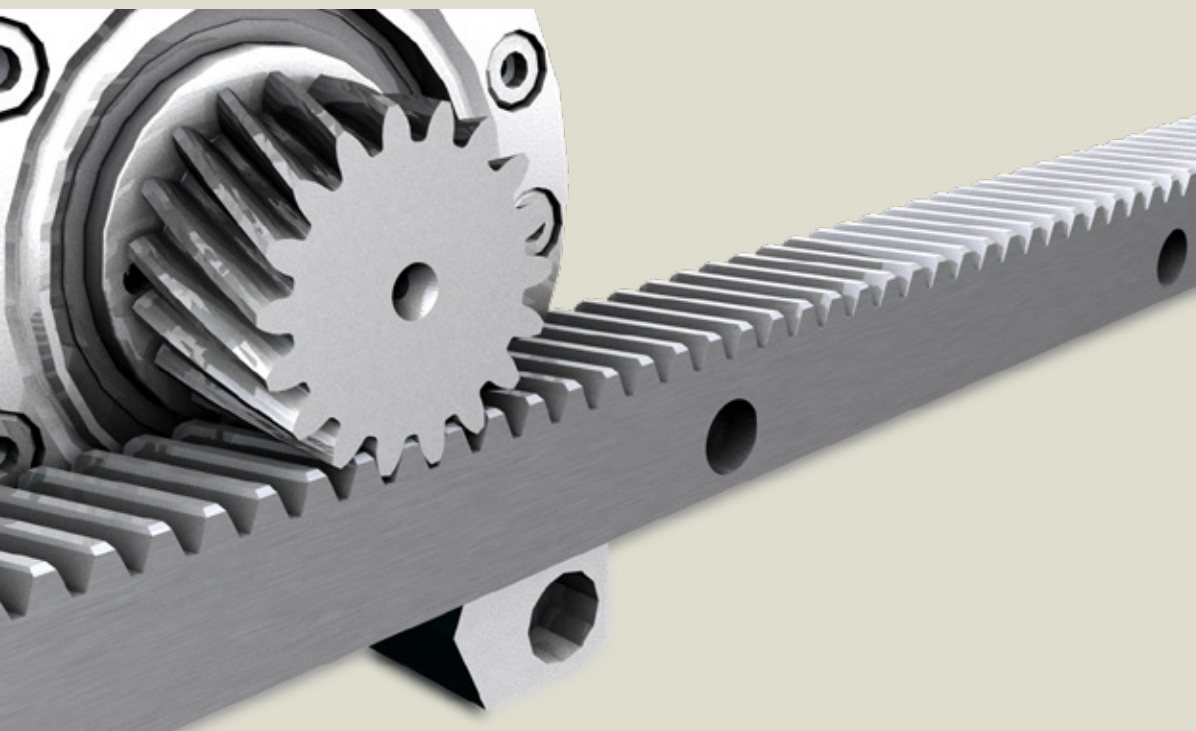

Sizes & Variants

Wide range of applications - one system

Imagine having picked certain components that eventually turn out not being suitable for your application. Don't worry! There's luckily no need to start all over again.

We have **over 60 possible variants** which allows you to create a new kit quite flexibly. We offer the highest freedom in regards to easy scalability of your products without having to invest more time and money than necessary.

BENEFITS DESIGN



compact design

universal mounting options

low weight

adaptable servo motor
adaptation due to flexible
intermediate flanges

System solutions

System benefits

very smooth running

high wear resistance by using
high-performance materials

high energy efficient / high
efficiency level

suitable for all operating
positions

corrosion protection through
stainless steel version or special
coatings (optionally)



Rack & Pinion benefits

highest resilience through
optimal choice of material and
heat treatment

high wear resistance through
the use of high-performance
materials

very smooth running due to low
manufacturing tolerances

high overall efficiency level

vibration and shock absorbing

Servo gearbox benefits

high torsional rigidity

vibration and shock absorbing

corrosion protection through
stainless steel version or special
coatings (optionally)

adjustable toothing backlash

food grade oil with H1-
authorization

Hermetic pressure equalization

membrane ensures pressure
equalization

no gearbox venting necessary

no oil leakage possible

integrated in the gearbox housing

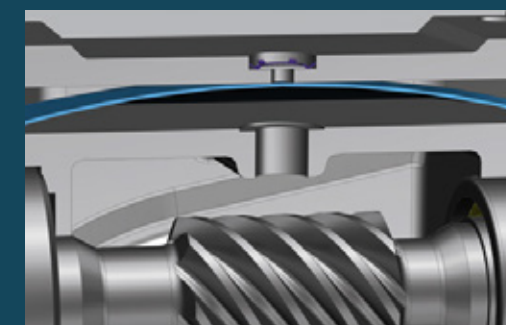
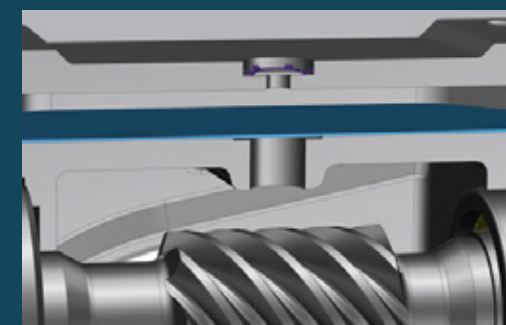

Technical data

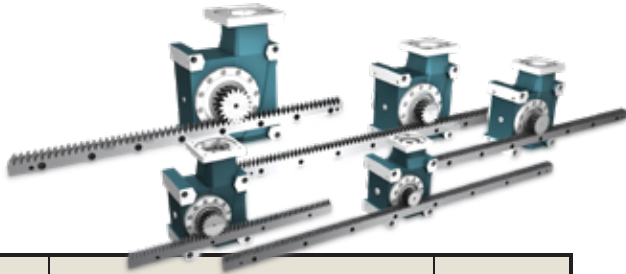

1 3 7

Gearbox size / center distance	Translation ratio	Teeth number pinion	max. input speed (min ⁻¹)	Module	Toothing width (mm)	Torque		Linear speed rack at 1.500min (mm/s)	Linear force				backlash (arcmin)
						M_v2* (Nm)	M_S1** (Nm)		M_v2 (Nm)	F(M_v2) (N)	M_s1 (Nm)	F(M_s1) (N)	
040	4,0	18	8.000	2	20	37,0	59,0	756	37	1.937,3	59	3.089,2	Eco: < 6 Performance: < 3
	6,4					48,0	82,0	472	48	2.513,3	82	4.293,5	
	10,0					52,0	87,0	303	52	2.722,7	87	4.555,3	
	16,0					53,0	84,0	190	53	2.775,1	84	4.398,2	
	27,0					61,0	89,0	113	61	3.193,9	89	4.660,0	
	39,0					43,0	73,0	76,6	43	2.251,5	73	3.822,3	
050	4,0	20	7.000	2,5	25	110,0	120,0	1.042	110	4.146,9	120	4.523,9	Eco: < 6 Performance: < 3
	6,4					120,0	130,0	650	120	4.523,9	130	4.900,9	
	10,0					129,0	160,0	417	129	4.863,2	160	6.031,8	
	16,0					125,0	160,0	261	125	4.712,4	160	6.031,8	
	27,0					137,0	160,0	156	137	5.164,8	160	6.031,8	
	39,0					115,0	159,0	106	115	4.335,4	159	5.994,1	
063	4,0	20	5.500	3	30	257,0	194,0	1.250	257	8.073,9	194	6.094,7	Eco: < 6 Performance: < 2
	6,4					265,0	249,0	780	265	8.325,2	249	7.822,6	
	10,0					279,0	282,0	500	279	8.765,0	282	8.859,3	
	16,0					274,0	282,0	313	274	8.608,0	282	8.859,3	
	27,0					283,0	283,0	187	283	8.890,7	283	8.890,7	
	39,0					247,0	283,0	127	247	7.759,7	283	8.890,7	
080	4,0	16	4.500	4	40	506,0	415,0	1.365	506	14.902,9	415	12.222,7	Eco: < 6 Performance: < 2
	6,4					507,0	495,0	852	507	14.932,4	495	14.578,9	
	10,0					508,0	508,0	546	508	14.961,8	508	14.961,8	
	16,0					508,0	508,0	342	508	14.961,8	508	14.961,8	
	27,0					508,0	508,0	204	508	14.961,8	508	14.961,8	
	39,0					495,0	508,0	138	495	373,8	508	14.961,8	
100	4,0	18	3.600	5	50	900,0	700,0	1.914	900	18.849,5	700	14.660,7	Eco: < 6 Performance: < 2
	6,4					1.085,0	870,0	1.195	1.085	22.724,2	870	18.221,2	
	10,0					1.152,0	1.100,0	766	1.152	24.127,4	1.100	23.038,3	
	16,0					1.130,0	1.153,0	480	1.130	23.666,6	1.153	24.148,3	
	27,0					1.154,0	1.120,0	286	1.154	24.169,3	1.120	23.457,2	
	39,0					1.030,0	1.150,0	194	1.030	21.572,2	1.150	24.085,5	

* Torsional backlash constant acceleration torque (servo application with a lifetime of 20.000 h (at ED 30 %))
** S1 continuous operation, 1.500 r/min, thermal limits not considered

2 Gearbox arrangement

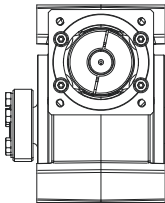

05:
pinion positioning
right

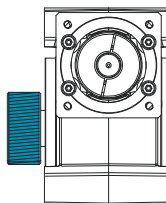

06:
pinion positioning
left

One system - two variants 6

1 - PERFORMANCE

- » Reduced backlash
- » Force-fitting shaft connection (shrink disk)

2 - ECO

- » Standard backlash
- » Force-fitting shaft connection (keyway)

Order code

063-05-16.0:1-130/165/M05/24x50-N-1-20-1-11250
1 2 3 4 5 6 7 8 9

1 Sizes
040 | 050 | 063 | 080 | 100

2 Gearbox arrangements
05: Pinion positioning right
06: Pinion positioning left

3 Translation ratio
04.0:1 | 06.4:1 | 10.0:1
16.0:1 | 27.0:1 | 39.0:1

4 Dimensions of the flange
for motor mounting
ø centering | ø bolt circle
thread | motor shaft øDxL

5 Coupling variant (for motor)
G: For smooth motor shaft without keyway
N: For motor shaft with keyway

6 Variant -
1 Performance / 2 Eco

7 teeth number pinion

8 Toothing -
1 helical toothed / 2 straight toothed

9 rack length [mm]

Contact

✉ systemloesungen@herionlinner.com

☎ +49 8442 9699 280



CAD data available upon request.



For further technical information
please visit our download center.
www.herionlinner.com/en/download

Accessories

All-round carefree with automated maintenance

Toothed components need to be maintained on a regular basis. Doing so, not only the availability of the product can be increased, but also the overall lifespan extended. Our **automated maintenance** options simply take over these processes - without any need of human interaction.

Having chosen the correct overall package, you can therefore easily lean back and relax on this particular topic. Our solutions range from different lubrication pinions, lubrication pumps to varying lubricants themselves. You will definitely be able to find the right components in order to meet your individual requirements.



Customized production

Individual production, delivered quickly - WMH Herion as a component and system manufacturer

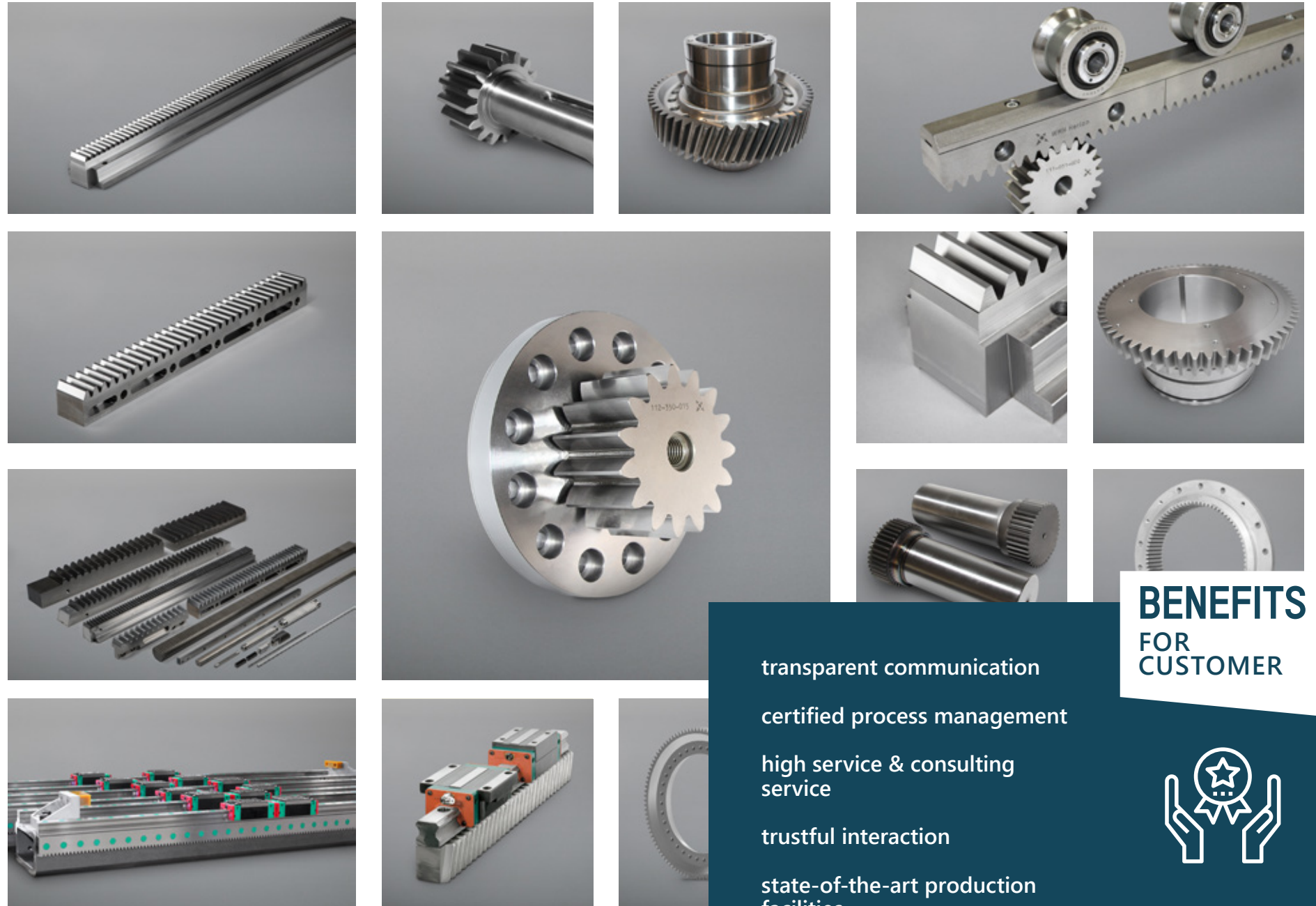

BENEFITS FOR CUSTOMER

- transparent communication
- certified process management
- high service & consulting service
- trustful interaction
- state-of-the-art production facilities
- best quality



SYSTEM OF YOUR DRIVE



Drive system from A to Z - the
single source all-in-one package



WMH Herion Antriebstechnik GmbH
Stanglmühle 9 - 11
D-85283 Wolnzach

t. +49 8442 9699 280
e. systemloesungen@herionlinner.com

www.herionlinner.com

  @wmhherionlinner

